

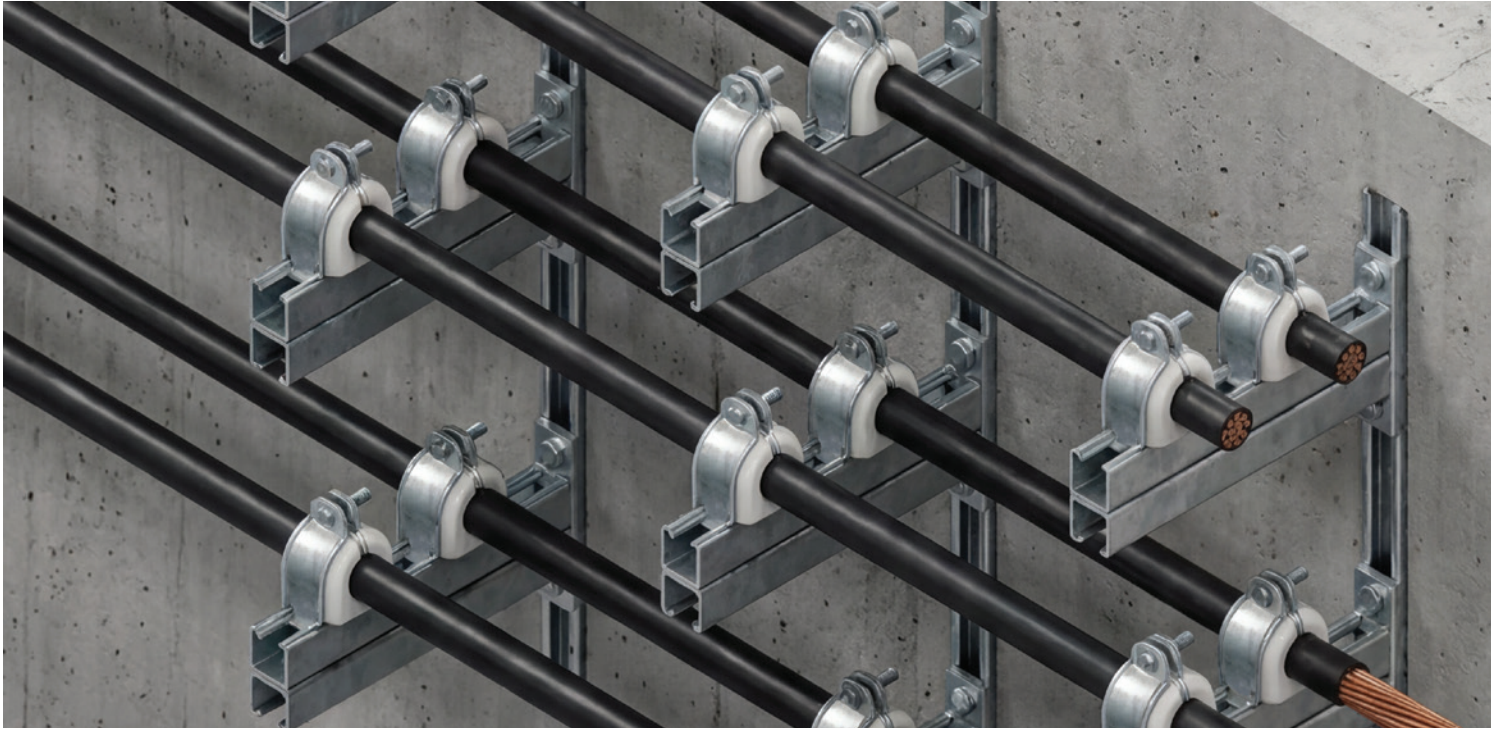

UNDERGROUND VAULT ELECTRICAL SUPPORTS

SOLUTIONS THAT SUPPORT CRITICAL INFRASTRUCTURE – SECURE. RELIABLE. FUTURE-READY.



Why Underground Vault Systems Are Being Used

- **Enhanced Reliability:**
Protected from weather, environmental damage, and external impact—supporting critical uptime requirements
- **High-Capacity Power Delivery:**
Designed to handle the massive electrical loads required by modern data centers
- **Improved Accessibility:**
Allows safe, controlled access for maintenance, upgrades, and future expansion without excavation
- **Optimized Site Design:**
Eliminates overhead congestion and supports cleaner, more efficient facility layouts

Why Support Systems Matter Inside Vaults

- **Critical Cable Management:**
Safely supports and organizes large, high-voltage cable runs under demanding conditions
- **Engineered for Performance:**
Designed to withstand heavy loads, fault forces, and long-term environmental exposure
- **Adaptable Solutions:**
Compatible with both metallic and non-metallic systems to meet project-specific requirements

Wesanco-ZSi.com | 800-323-7053

ZSi & Wesanco are part of the Ideal Tridon Group. Learn more at idealtridongroup.com



Advantages of Non-Metallic Systems

- Corrosion Resistant:**
 Ideal for damp, underground environments with no risk of rust or coating failure
- Low Maintenance:**
 Long service life with minimal upkeep required over time
- Lightweight & Easy Installation:**
 Reduces labor time and simplifies handling in tight vault spaces
- Electrically Non-Conductive:**
 Eliminates stray current concerns and enhances safety in certain applications
- Consistent Performance:**
 Not dependent on coatings or finishes that can degrade in harsh conditions

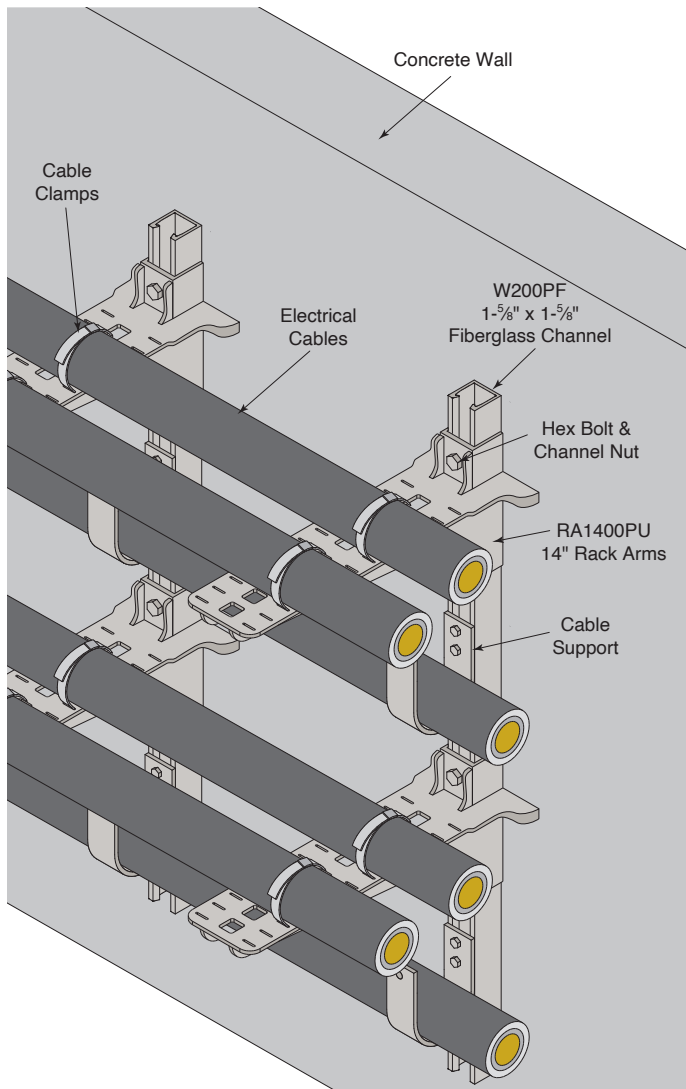
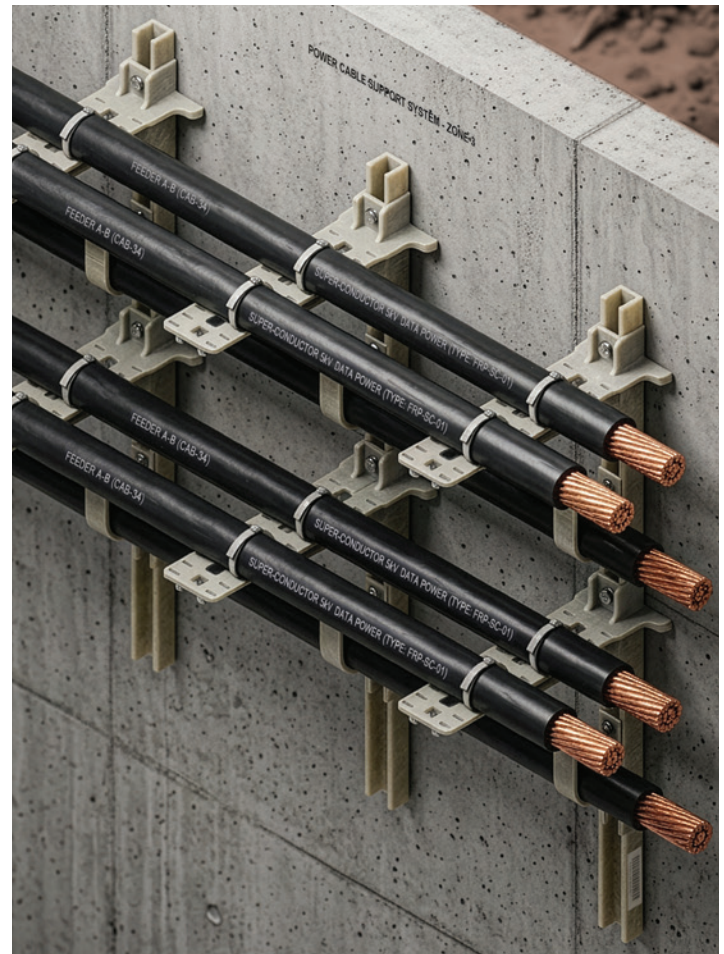

1 5/8" x 1 5/8" (41 x 41mm) Solid & Slotted Channel		Rack Arms	
W200 Series		RA1400PU – RA2000NY	
Fiberglass Cable Support	Cable Clamp	Channel Spring Nuts	Spring Nut Hex Bolts
--	--	W5-4FG – W2-8FG	HHCS Series

Advantages of Metallic Systems

- Superior Strength:**
 Handles heavy cable loads and withstands mechanical stress, including fault conditions
- Grounding Capability:**
 Can be bonded and integrated into the electrical grounding system
- Non-Combustible:**
 Ideal for applications with strict fire and safety requirements
- High Load Capacity:**
 Supports larger, high-density cable installations with wider span capability
- Proven Durability:**
 Long-standing, widely accepted solution across utility and industrial applications

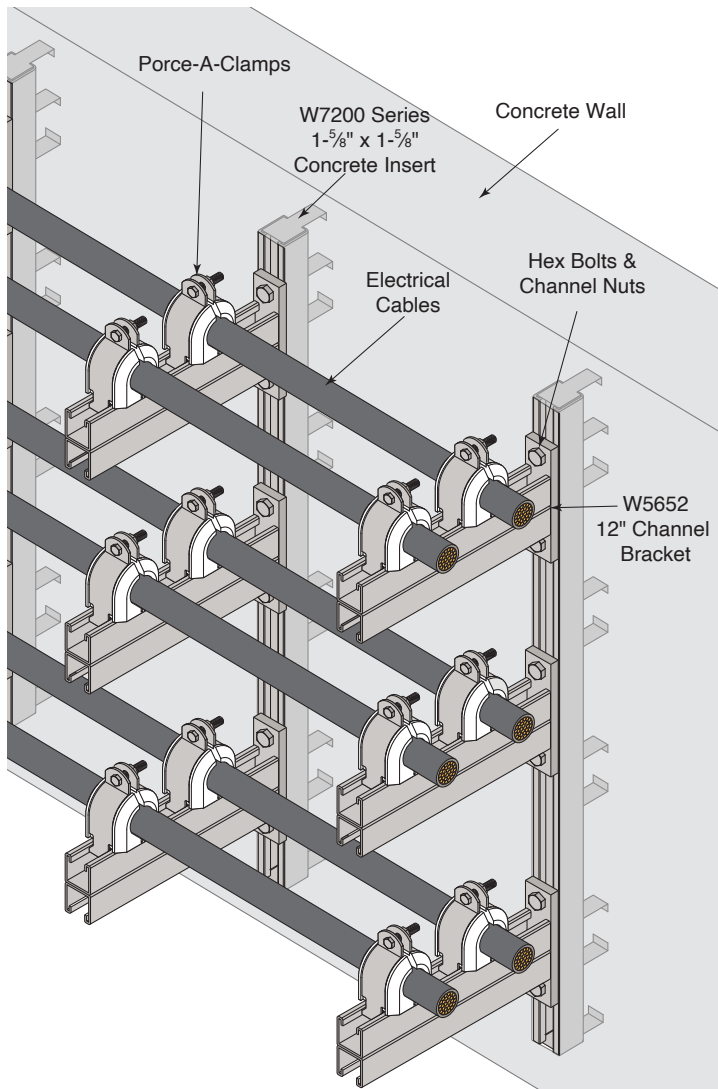
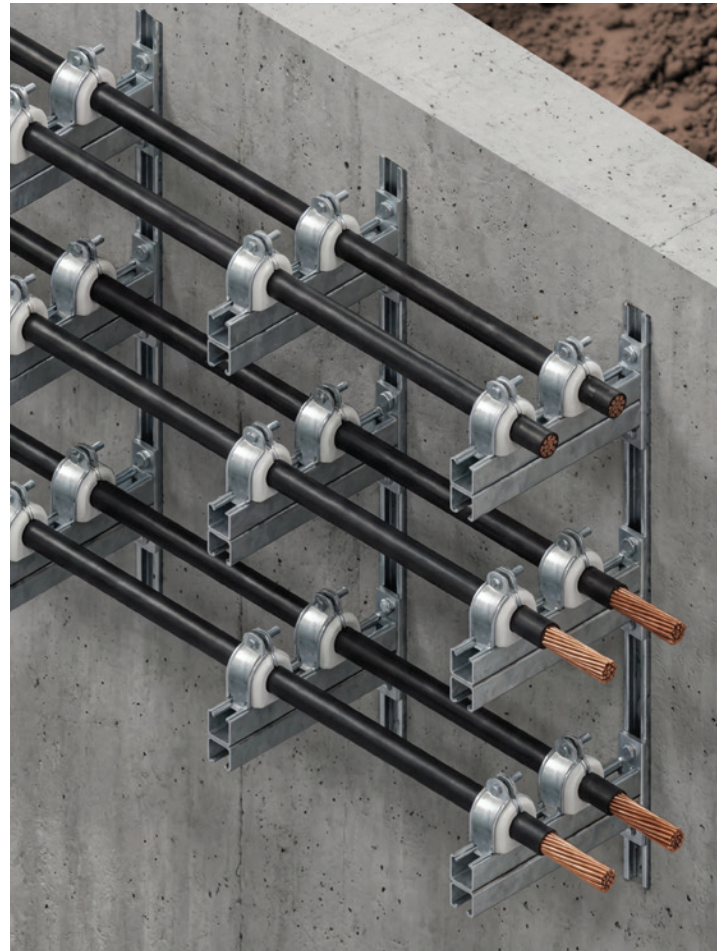

Continuous Concrete Insert 1-5/8" x 1-5/8" 12 Gauge Channel		2-Hole, 3/8" Plate with Double 1-5/8" Channel Bracket
W7200 Series		W5652 - W5656
Porce-A-Clamp®	Channel Nut with Standard Spring	Hex Head Cap Screw
006CC018 - 072CC080	W2-x Series	HHCS Series

Porce-A-Clamp® Cable Clamp

The hinged cushion allows easy installation of the wire, but the components will not get separated and lost or broken.

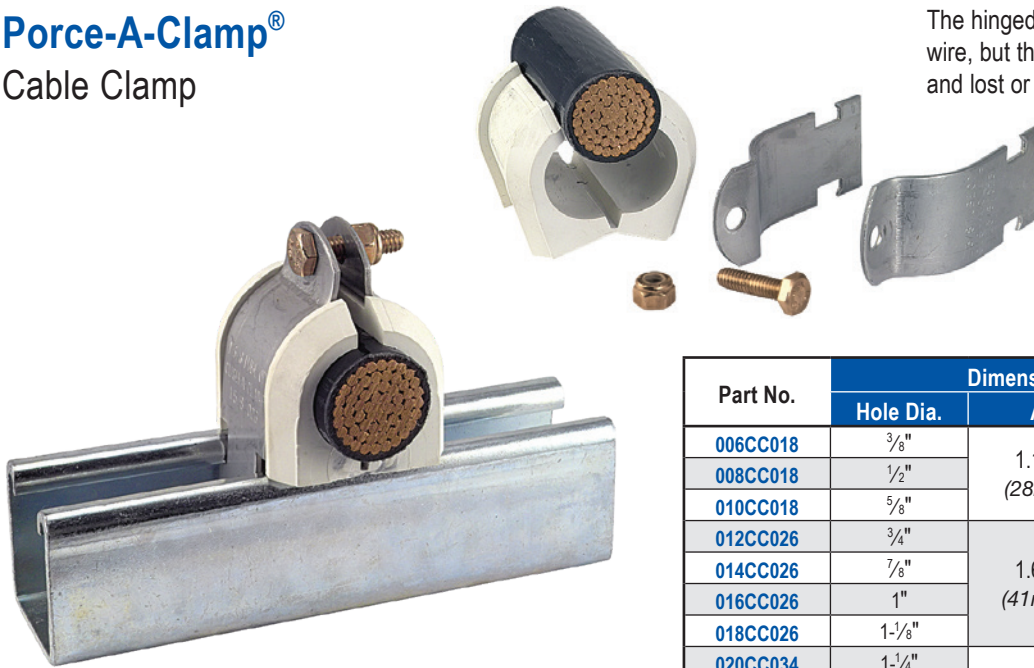

Replaces Porcelain and Maple Cable Clamp. Assembly consists of thermoplastic elastomer cushion with plated or stainless steel clamp. Plated steel and stainless are both supplied with Silicon Bronze bolt and nut.

- Non-breakable material
- Chemical and UV resistant
- **U.L. Listed** - Burning stops within 10 seconds after two applications of ten seconds each of a flame to a test bar with no flaming drips.
- Plated Steel, or Stainless steel clamps
- Tapered flange to protect cable
- Dielectric strength 640 volts per mil
- One piece cushion design, available with Flame retardant / Halogen Free cushions
- Silicon Bronze Hardware used to Breakup the Magnetic field around the Cable at the Clamping Location.

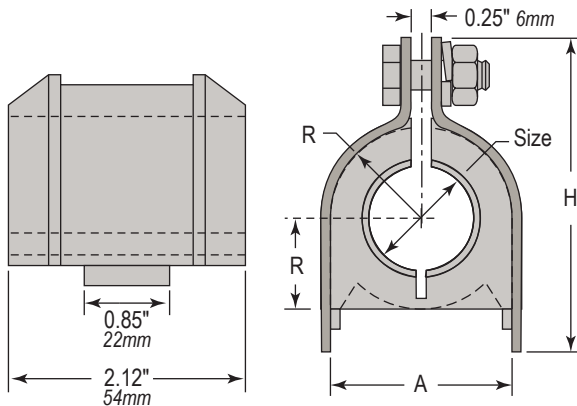

Part No.	Dimensions (In.)			Total Assy. Height - H
	Hole Dia.	A	R	
006CC018	3/8"	1.12" (28mm)	0.56" (14mm)	1.82" (46mm)
008CC018	1/2"			
010CC018	5/8"			
012CC026	3/4"	1.62" (41mm)	0.81" (21mm)	2.34" (59mm)
014CC026	7/8"			
016CC026	1"			
018CC026	1-1/8"			
020CC034	1-1/4"	2.12" (54mm)	1.06" (27mm)	2.86" (73mm)
022CC034	1-3/8"			
024CC034	1-1/2"			
026CC034	1-5/8"			
028CC042	1-3/4"			
030CC042	1-7/8"	2.62" (67mm)	1.31" (33mm)	3.50" (89mm)
032CC042	2"			
034CC042	2-1/8"			
036CC050	2-1/4"	3.12" (79mm)	1.56" (40mm)	4.05" (103mm)
038CC050	2-3/8"			
040CC050	2-1/2"			
042CC050	2-5/8"			
044CC058	2-3/4"			
046CC058	2-7/8"	3.62" (92mm)	1.81" (46mm)	4.75" (121mm)
048CC058	3"			
050CC058	3-1/8"			
052CC066	3-1/4"	4.12" (105mm)	2.06" (52mm)	5.125" (130mm)
054CC066	3-3/8"			
056CC066	3-1/2"			
058CC066	3-5/8"			
060CC074	3-3/4"			
062CC074	3-7/8"	4.62" (117mm)	2.31" (59mm)	5.54" (141mm)
064CC074	4"			
066CC074	4-1/8"			
068CC080	4-1/4"	5.00" (127mm)	2.50" (64mm)	5.92" (150mm)
070CC080	4-3/8"			
072CC080	4-1/2"			

Note: All clamps have Silicon Bronze Hardware

SUFFIX	Clamp	Cushion	Example
Z	Plated Steel	Flame Retardant	006CC018Z
S	Stainless Steel	Flame Retardant	006CC018S
ZH	Plated Steel	Flame Retardant Halogen Free	006CC018ZH
SH	Stainless Steel	Flame Retardant Halogen Free	006CC018SH

Wesanco-ZSi.com | 800-323-7053

ZSi & Wesanco are part of the Ideal Tridon Group. Learn more at idealtridongroup.com

© Copyright 2026 Ideal Tridon Group / Printed & Designed in the USA / 04-26

